

OWNER'S MANUAL

PX Series Boom Assemblies

Models:

PX413-ASM (5281706)
 PX416-ASM (5281708)
 PX420-ASM (5281710)
 PX423-ASM (5281712)
 PX620-ASM (5281714)
 PX623-ASM (5281716)
 PX626-ASM (5281718)
 PX630-ASM (5281720)

Models:

PX413-QJD (5281705)
 PX416-QJD (5281707)
 PX420-QJD (5281709)
 PX423-QJD (5281711)
 PX620-QJD (5281713)
 PX623-QJD (5281715)
 PX626-QJD (5281717)
 PX630-QJD (5281719)

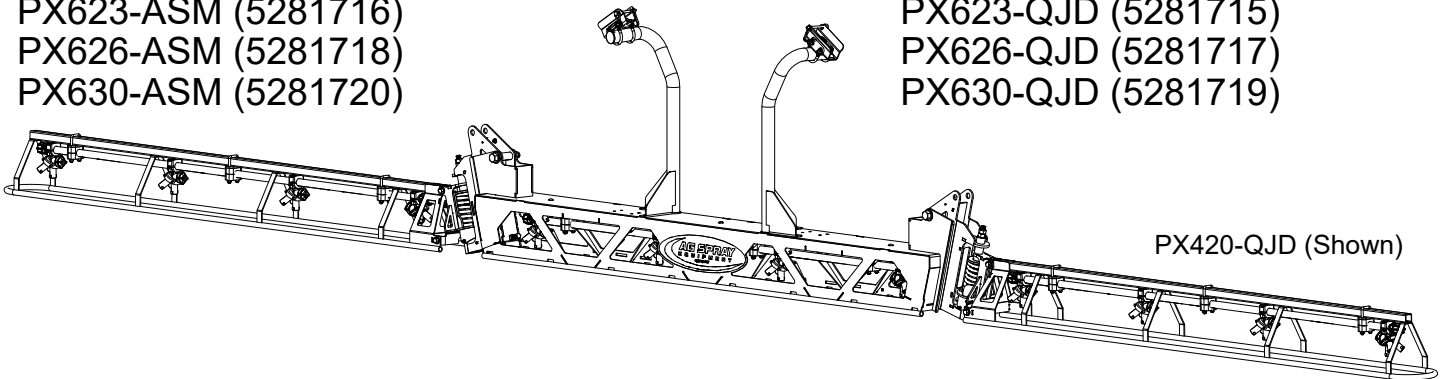

WARNING: Always be aware of surroundings when folding and unfolding boom, especially overhead powerlines.

General Information

Thank You and Congratulations on purchasing your new boom. The purpose of this manual is to assist you in operating and maintaining your boom.

Please read it carefully, as it furnishes information which will help you achieve years of trouble-free operation.



WARNING: To reduce the risk of injury, the user must read and understand the operator's manual before using this product.



WARNING: Cancer and Reproductive Harm
www.P65Warnings.ca.gov

Any Questions, Comments or Problems: Call your nearest AG SPRAY Location and speak with one of our Friendly Technical Support Staff.



[5195625

(05/21)]

BAKERSFIELD, CA 877-724-2236	COLUMBUS, NE 800-274-1025	DOTHAN, AL 800-227-4098	FARGO, ND 701-280-2862	HOPKINSVILLE, KY 800-637-7172	VISIT US ONLINE @ WWW.AGSPRAY.COM
MANKATO, MN 507-388-6295	NEWTON, KS 800-394-7662	PASCO, WA 800-634-2026	TEMPE, AZ 877-974-7166		

PX4 - 80" Center Section Assembly

Ref. #	Part #	Description	Qty.
1	5281736	Assembly PX Boom 4-Nozzle Center Section	1
1.1	5281746	PX Boom 4-Nozzle Center Section	1
1.2	5051169	1/4-20 Carriage Bolt	3
1.3	5011292	4-Nozzle Tube, PX Boom Center	1
1.4	5006344	1/4-20 Flanged Top-Lock Hex Nut	3
1.5	5034726	5/8-11 x 3.50 Flanged Hex Bolt (Full Thread)	2
1.6	5281751	PX Boom Folding Break-Away Hinge	2
1.6.1	5281742	PX Boom Fold Hinge Weldment	1
1.6.2	5034857	1/2-13 x 9" Carriage Bolt	1
1.6.3	5019758	Compression Spring, .375 Wire x 2.187 OD x 4 L	1
1.6.4	5108135	Coiled Spring Retainer	1
1.6.5	5041210	PX Boom Spring Retainer Bushing	1
1.6.6	5281741	PX Boom Pivot Hinge Weldment	1
1.6.7	5012015	Grease Zerk, 1/4-28 Thread	2
1.6.8	5101373	Spring Pin, 0.5" Dia. X 3" Long	1
1.6.9	5006011	1/2-13 Hex Nut	2
1.7	5006201	5/8-11 Top-Lock Hex Nut	2
1.8	5034665	3/8-16 x 2.00 Flanged Hex Bolt (Full Thread)	2

Ref. #	Part #	Description	Qty.
1.9	5006345	3/8-16 Flanged Top-Lock Hex Nut	6
1.10	5034660	3/8-16 x 0.75 Flanged Hex Bolt	4
1.11	5034288	3/8-16 x 2.75 Hex Bolt (Full Thread)	2
1.12	5006362	3/8-16 Hex Jam Nut	2
1.13	5040026	Rubber Bumper, 3/8-16 Female Thread	2
1.14	5117167	#10-24 x 0.625 PH Truss Head Mach Screw	2
1.15	5051152	3/4" Black Nylon Loom Clamp	2
1.16	5006186	#10-24 Serrated Flanged Hex Nut	2
2	5281738	Kit, PX Boom Cradle	1
2.1	5034481	1/4-20 x 0.75 Carriage Bolt	8
2.2	5281750	PX Boom Cradle Weldment	2
2.3	5006344	1/4-20 Flanged Top-Lock Hex Nut	8
2.4	5046460	Tube Cap, 1 1/2 OD x 1.23-1.33 ID	2
2.5	5034065	5/16-18 x 1.5 x 2.1875 Round U-Bolt	4
2.6	5038957-CBK	Wet Boom Clamp Bracket - PX Boom	2
2.7	5040028	Rubber Bumper 1.00 OD x 3/16 Tall	4
2.8	5006389	5/16-18 Flanged Top Lock Hex Nut	8
2.9	5101376	Lynch Pin, 1/4" Dia. X 2 1/8" Usable Length	2

Important - PX Series Booms are equipped with Safety Transport Lynch Pins (Ref. 2.9).

Lynch pins must be removed before unfolding boom.

Lynch pins must be installed once PX Boom is folded before transport.

Failure to follow these procedures can result in boom or property damage.

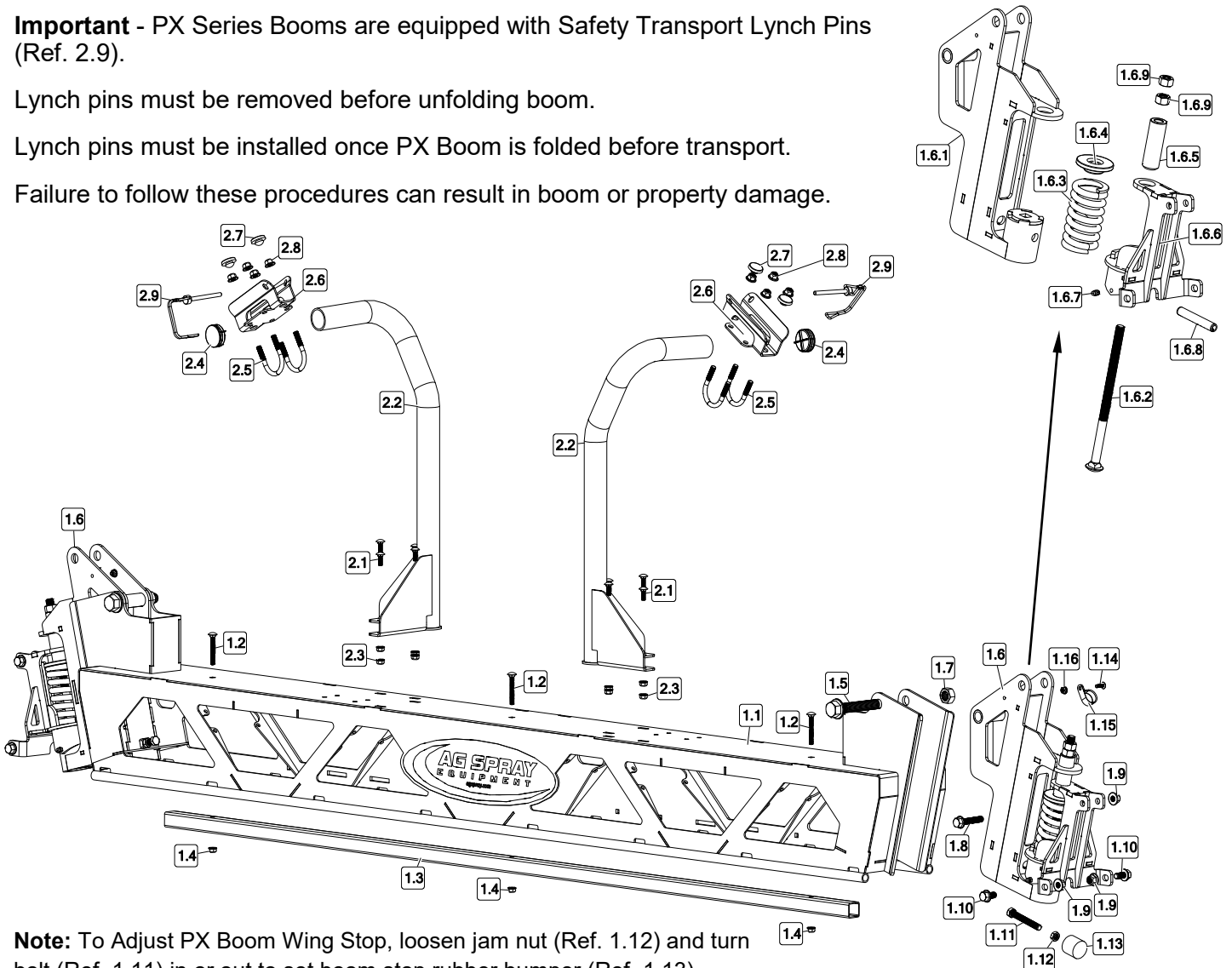

Note: To Adjust PX Boom Wing Stop, loosen jam nut (Ref. 1.12) and turn bolt (Ref. 1.11) in or out to set boom stop rubber bumper (Ref. 1.13).

PX4 BOOM Single QuickJet Diaphragm (QJD) Nozzle Bodies

Ref. #	Part #	Description	PX413-QJD	PX416-QJD	PX420-QJD	PX423-QJD
			Qty.	Qty.	Qty.	Qty.
1	5281736	Assembly PX Boom 4-Nozzle Center Section	1	1	1	1
2	5281732-CBK	PX Boom Wing Weldment, 2-Nozzle	2	-	-	-
3	5281733-CBK	PX Boom Wing Weldment, 3-Nozzle	-	2	-	-
4	5281731-CBK	PX Boom Wing Weldment, 4-Nozzle	-	-	2	-
5	5281734-CBK	PX Boom Wing Weldment, 5-Nozzle	-	-	-	2
6	5002489	Quick TeeJet Nozzle, 1/2" Single - Left	2	2	2	2
7	5002490	Quick TeeJet Nozzle, 1/2" Single - Right	2	2	2	2
8	5002491	Quick TeeJet Nozzle, 1/2" Single - Double	4	6	8	10
9	5006087	Locknut, Brass	8	10	12	14
10	5116019	Nozzle Strainer, Blue (50 Mesh)	8	10	12	14
11	AIXR11003VP	Air-Induction XR Flat Spray Tip	8	10	12	14
12	5046167	TeeJet Quick Cap (Blue) w/Gasket	8	10	12	14
13	EPDM12	1/2" - 200 PSI EPDM Spray Hose (Total Ft.)	53'	56'	59'	62'
14	HC08	Clamp, 1/2" Hose	15	19	23	27
15	5281730	Parts Bag PX Boom Clamp	8	10	12	14
15.1	5095981-CBK	QuickJet Nozzle Body Mount PX Boom	1	1	1	1
15.2	5034855	5/16-18 x 1.125" x 1.50" Square U-Bolt	1	1	1	1
15.3	5006307	5/16-18 Serrated Flanged Hex Nut	2	2	2	2
16	5086026	Poly Hose Tee, 1/2" HB	1	1	1	1

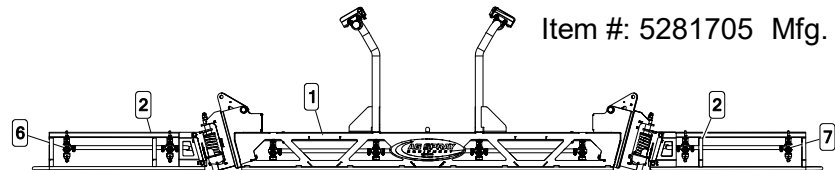
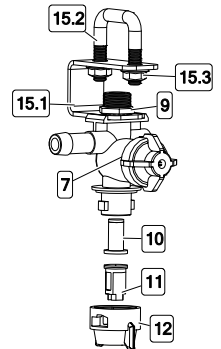
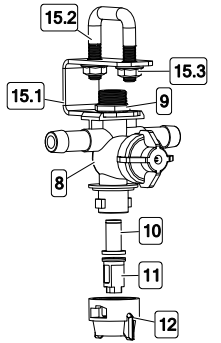
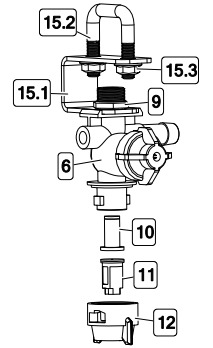

Item #: 5281705 Mfg. #: PX413-QJD

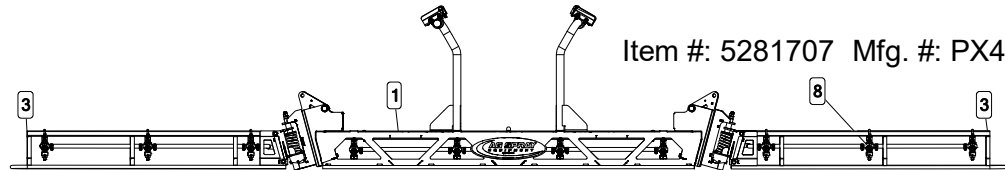

Item #: 5281707 Mfg. #: PX416-QJD

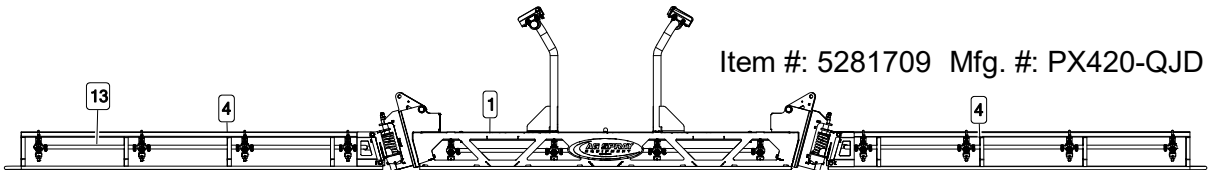

Item #: 5281709 Mfg. #: PX420-QJD

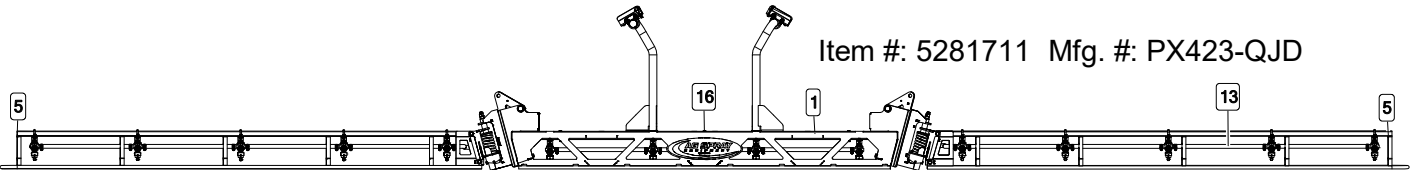

Item #: 5281711 Mfg. #: PX423-QJD

PX4 BOOM SST Wet Boom (ASM) Triple Nozzle Bodies

Ref. #	Part #	Description	PX413-ASM	PX416-ASM	PX420-ASM	PX423-ASM
			Qty.	Qty.	Qty.	Qty.
1	5281736	Assembly PX Boom 4-Nozzle Center Section	1	1	1	1
2	5281732-CBK	PX Boom Wing Weldment, 2-Nozzle	2	-	-	-
3	5281733-CBK	PX Boom Wing Weldment, 3-Nozzle	-	2	-	-
4	5281731-CBK	PX Boom Wing Weldment, 4-Nozzle	-	-	2	-
5	5281734-CBK	PX Boom Wing Weldment, 5-Nozzle	-	-	-	2
6	24216A-1/2-NYB	TeeJet 1/2" Pipe Wetboom Triple Nozzle Body	8	10	12	14
7	5281721	Kit, Wilger 1/2" Wet Boom 13' x 3 Sect 20" Off Cntr	1	-	-	-
7.1	5011285	1/2" Wet Boom Pipe, 23.750"L, 20" Spacing	2	-	-	-
7.2	5011286	1/2" Wet Boom Pipe, 30.595"L, 20" Spacing	2	-	-	-
7.3	5034856	QN 1/2" SST Nut	7	-	-	-
7.4	5072544	O-Ring	9	-	-	-
7.5	5118211	QN Hose Shank 1/2" SST x 1/2" Straight	1	-	-	-
7.6	5149203	QN Hose Shank - 1/2" SST x 1/2" Sweep, 90°	2	-	-	-
7.7	5149204	QN Sweep Tee - 1/2" SST x 1/2" SST x 1/2" SST	1	-	-	-
7.8	5149205	QN Plug - 1/2" SST x Plug Cap	4	-	-	-
7.9	5149207	QN Male Tube End Adapter - 0.840" x 1/2" SST	OPT	-	-	-
8	5281722	Kit, Wilger 1/2" Wet Boom 16' x 3 Sect 20" Off Cntr	-	1	-	-
8.1	5011287	1/2" Wet Boom Pipe, 43.750"L, 20" Spacing	-	2	-	-
8.2	5011286	1/2" Wet Boom Pipe, 30.595"L, 20" Spacing	-	2	-	-
8.3	5034856	QN 1/2" SST Nut	-	7	-	-
8.4	5072544	O-Ring	-	9	-	-
8.5	5118211	QN Hose Shank 1/2" SST x 1/2" Straight	-	1	-	-
8.6	5149203	QN Hose Shank - 1/2" SST x 1/2" Sweep, 90°	-	2	-	-
8.7	8149204	QN Sweep Tee - 1/2" SST x 1/2" SST x 1/2" SST	-	1	-	-
8.8	5149205	QN Plug - 1/2" SST x Plug Cap	-	4	-	-
8.9	5149207	QN Male Tube End Adapter - 0.840" x 1/2" SST	-	OPT	-	-
9	5281723	Kit, Wilger 1/2" Wet Boom 20' x 3 Sect 20" Off Cntr	-	-	1	-
9.1	5011284	1/2" Wet Boom Pipe, 63.750"L, 20" Spacing	-	-	2	-
9.2	5011286	1/2" Wet Boom Pipe, 30.595"L, 20" Spacing	-	-	2	-
9.3	5034856	QN 1/2" SST Nut	-	-	7	-
9.4	5072544	O-Ring	-	-	9	-
9.5	5118211	QN Hose Shank 1/2" SST x 1/2" Straight	-	-	1	-
9.6	5149203	QN Hose Shank - 1/2" SST x 1/2" Sweep, 90°	-	-	2	-
9.7	8149204	QN Sweep Tee - 1/2" SST x 1/2" SST x 1/2" SST	-	-	1	-
9.8	5149205	QN Plug - 1/2" SST x Plug Cap	-	-	4	-
9.9	5149207	QN Male Tube End Adapter - 0.840" x 1/2" SST	-	-	OPT	-
10	5281724	Kit, Wilger 1/2" Wet Boom 23' x 3 Sect 20" Off Cntr	-	-	-	1
10.1	5011289	1/2" Wet Boom Pipe, 83.750"L, 20" Spacing	-	-	-	2
10.2	5011286	1/2" Wet Boom Pipe, 30.595"L, 20" Spacing	-	-	-	2
10.3	5034856	QN 1/2" SST Nut	-	-	-	7
10.4	5072544	O-Ring	-	-	-	9
10.5	5118211	QN Hose Shank 1/2" SST x 1/2" Straight	-	-	-	1
10.6	5149203	QN Hose Shank - 1/2" SST x 1/2" Sweep, 90°	-	-	-	2
10.7	8149204	QN Sweep Tee - 1/2" SST x 1/2" SST x 1/2" SST	-	-	-	1
10.8	5149205	QN Plug - 1/2" SST x Plug Cap	-	-	-	4
10.9	5149207	QN Male Tube End Adapter - 0.840" x 1/2" SST	-	-	-	OPT
11	5281729	Parts Bag, 1/2" Wet Boom Clamp Kit	8	8	10	12
11.1	5034858	1/4-20 x 1.05 x 3.00 Square U-Bolt	1	1	1	1
11.2	5038958-CBK	WET BOOM CLAMP BRACKET - PX BOOM	1	1	1	1
11.3	5051174	1/2 Wet Boom Clamp (2 Halves)	1	1	1	1
11.4	5006344	1/4-20 Flanged Top-Lock Hex Nut	2	2	2	2

PX4 BOOM SST Wet Boom (ASM) Triple Nozzle Bodies

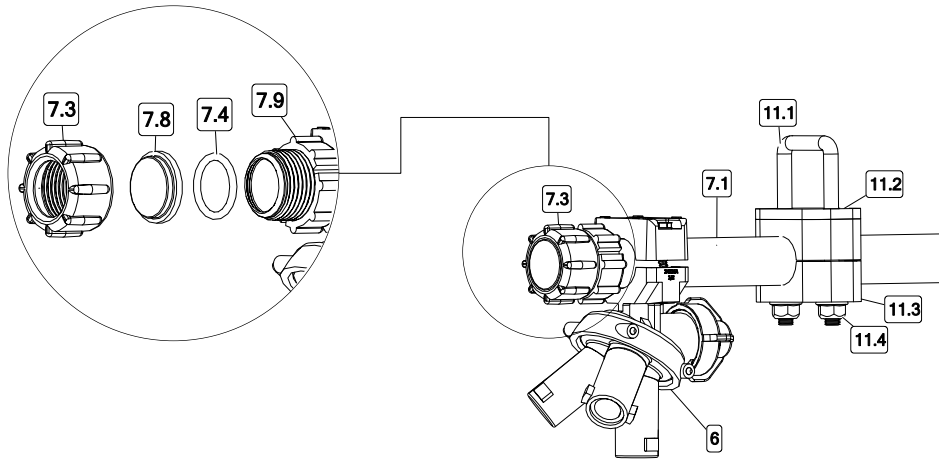
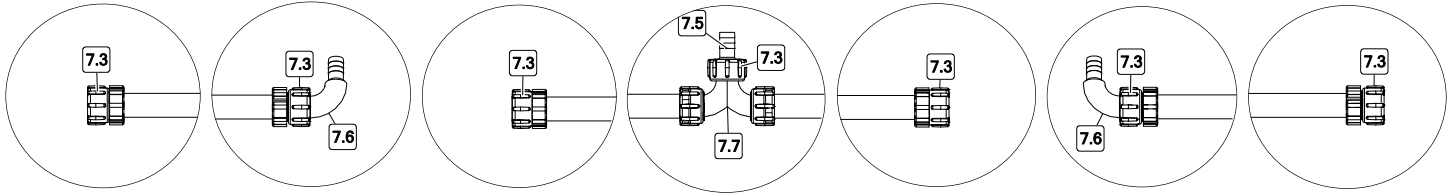

NOTE:
For parts 8.* , 9.* or 10.* , refer to part numbers for 7.*

Examples:
8.3, 9.3, 10.3 would be the same part number as 7.3.
8.5, 9.5, 10.5 would be the same part number as 7.5 and so on.

Refer below for placements of 7.1, 7.2, 8.1, 8.2, 9.1, 9.2, 10.1 & 10.2 as boom pipes are different lengths.

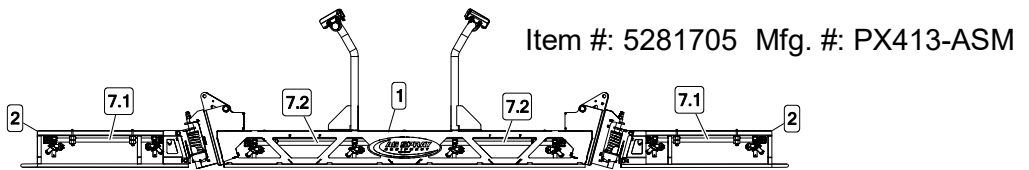

Item #: 5281705 Mfg. #: PX413-ASM

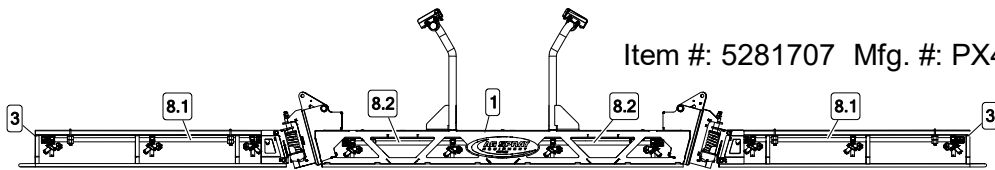

Item #: 5281707 Mfg. #: PX416-ASM

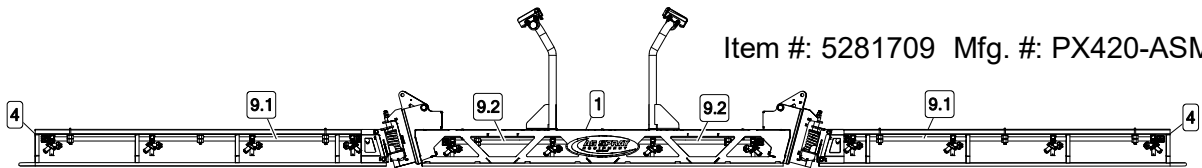

Item #: 5281709 Mfg. #: PX420-ASM

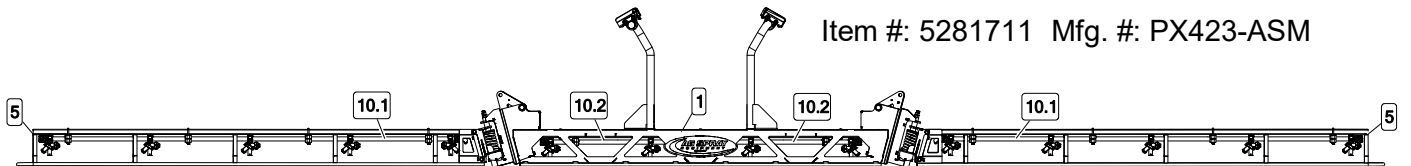

Item #: 5281711 Mfg. #: PX423-ASM

PX6 - 120" Center Section Assembly

Ref. #	Part #	Description	Qty.
1	5281737	Assembly PX Boom 6-Nozzle Center Section	1
1.1	5281749-CBK	PX Boom 6-Nozzle Center Section	1
1.2	5051169	1/4-20 Carriage Bolt	3
1.3	5011298-CBK	6-Nozzle Tube, PX Boom Center	1
1.4	5006344	1/4-20 Flanged Top-Lock Hex Nut	3
1.5	5034726	5/8-11 x 3.50 Flanged Hex Bolt (Full Thread)	2
1.6	5281751	PX Boom Folding Break-Away Hinge	2
1.6.1	5281742	PX Boom Fold Hinge Weldment	1
1.6.2	5034857	1/2-13 x 9" Carriage Bolt	1
1.6.3	5019758	Compression Spring, .375 Wire x 2.187 OD x 4 L	1
1.6.4	5108135	Coiled Spring Retainer	1
1.6.5	5041210	PX Boom Spring Retainer Bushing	1
1.6.6	5281741	PX Boom Pivot Hinge Weldment	1
1.6.7	5012015	Grease Zerk, 1/4-28 Thread	2
1.6.8	5101373	Spring Pin, 0.5" Dia. X 3" Long	1
1.6.9	5006011	1/2-13 Hex Nut	2
1.7	5006201	5/8-11 Top-Lock Hex Nut	2
1.8	5034665	3/8-16 x 2.00 Flanged Hex Bolt (Full Thread)	2

Ref. #	Part #	Description	Qty.
1.9	5006345	3/8-16 Flanged Top-Lock Hex Nut	6
1.10	5034660	3/8-16 x 0.75 Flanged Hex Bolt	4
1.11	5034288	3/8-16 x 2.75 Hex Bolt (Full Thread)	2
1.12	5006362	3/8-16 Hex Jam Nut	2
1.13	5040026	Rubber Bumper, 3/8-16 Female Thread	2
1.14	5117167	#10-24 x 0.625 PH Truss Head Mach Screw	2
1.15	5051152	3/4" Black Nylon Loom Clamp	2
1.16	5006186	#10-24 Serrated Flanged Hex Nut	2
2	5281738	Kit, PX Boom Cradle	1
2.1	5034481	1/4-20 x 0.75 Carriage Bolt	8
2.2	5281750	PX Boom Cradle Weldment	2
2.3	5006344	1/4-20 Flanged Top-Lock Hex Nut	8
2.4	5046460	Tube Cap, 1 1/2 OD x 1.23-1.33 ID	2
2.5	5034065	5/16-18 x 1.5 x 2.1875 Round U-Bolt	4
2.6	5038957-CBK	Wet Boom Clamp Bracket - PX Boom	2
2.7	5040028	Rubber Bumper 1.00 OD x 3/16 Tall	4
2.8	5006389	5/16-18 Flanged Top Lock Hex Nut	8
2.9	5101376	Lynch Pin, 1/4" Dia. X 2 1/8" Usable Length	2

Important - PX Series Booms are equipped with Safety Transport Lynch Pins (Ref. 2.9).

Lynch pins must be removed before unfolding boom.

Lynch pins must be installed once PX Boom is folded before transport.

Failure to follow these procedures can result in boom or property damage.

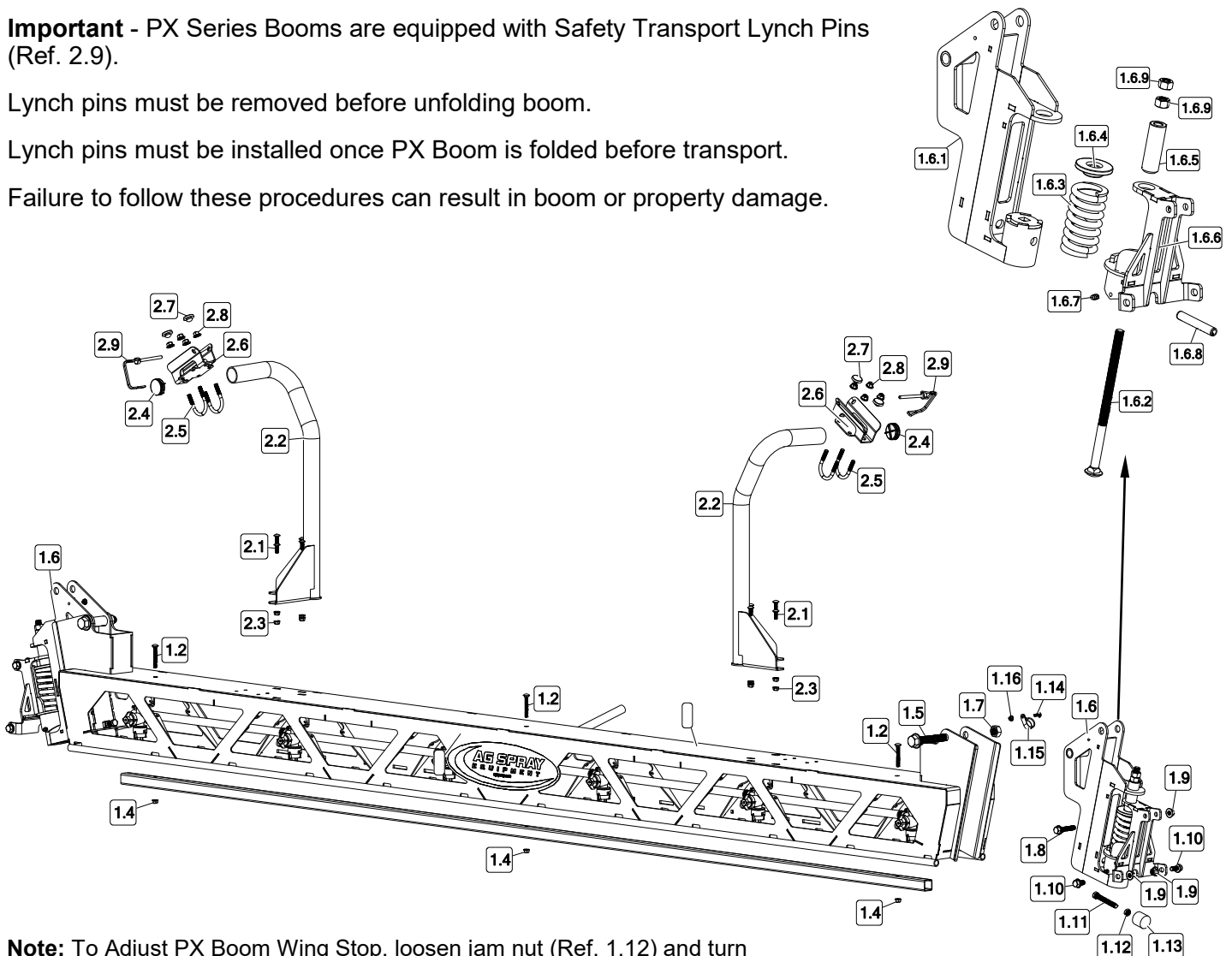

Note: To Adjust PX Boom Wing Stop, loosen jam nut (Ref. 1.12) and turn bolt (Ref. 1.11) in or out to set boom stop rubber bumper (Ref. 1.13).

PX6 BOOM Single QuickJet Diaphragm (QJD) Nozzle Bodies

Ref. #	Part #	Description	PX620-QJD	PX623-QJD	PX626-QJD	PX630-QJD
			Qty.	Qty.	Qty.	Qty.
1	5281737	Assembly PX Boom 6-Nozzle Center Section	1	1	1	1
2	5281733-CBK	PX Boom Wing Weldment, 3-Nozzle	2	-	-	-
3	5281731-CBK	PX Boom Wing Weldment, 4-Nozzle	-	2	-	-
4	5281734-CBK	PX Boom Wing Weldment, 5-Nozzle	-	-	2	-
5	5281735-CBK	PX Boom Wing Weldment, 6-Nozzle	-	-	-	2
6	5002489	Quick TeeJet Nozzle, 1/2" Single - Left	2	2	2	2
7	5002490	Quick TeeJet Nozzle, 1/2" Single - Right	2	2	2	2
8	5002491	Quick TeeJet Nozzle, 1/2" Single - Double	8	10	12	14
9	5006087	Locknut, Brass	12	14	16	18
10	5116019	Nozzle Strainer, Blue (50 Mesh)	12	14	16	18
11	AIXR11003VP	Air-Induction XR Flat Spray Tip	12	14	16	18
12	5046167	TeeJet Quick Cap (Blue) w/Gasket	12	14	16	18
13	EPDM12	1/2" - 200 PSI EPDM Spray Hose (Total Ft.)	59'	62'	65'	68'
14	HC08	Clamp, 1/2" Hose	23	27	31	35
15	5281730	Parts Bag PX Boom Clamp	12	14	16	18
15.1	5095981-CBK	QuickJet Nozzle Body Mount PX Boom	1	1	1	1
15.2	5034855	5/16-18 x 1.125" x 1.50" Square U-Bolt	1	1	1	1
15.3	5006307	5/16-18 Serrated Flanged Hex Nut	2	2	2	2
16	5086026	Poly Hose Tee, 1/2" HB	1	1	1	1

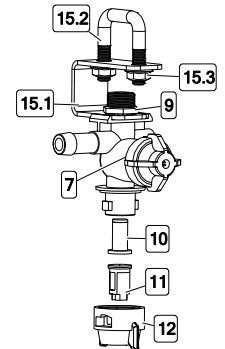
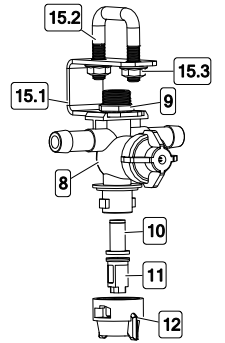
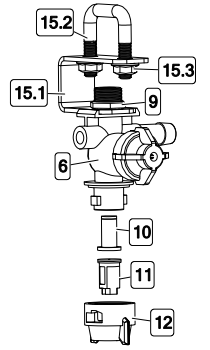

Item #: 5281713 Mfg. #: PX620-QJD

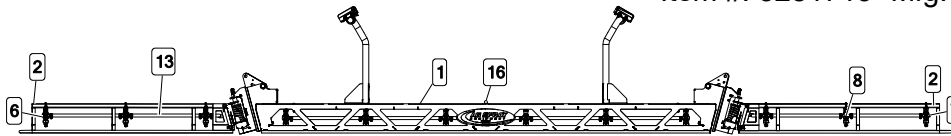

Item #: 5281715 Mfg. #: PX623-QJD

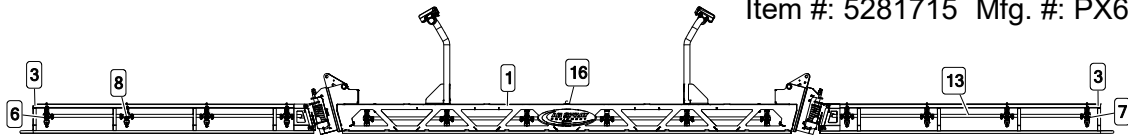

Item #: 5281717 Mfg. #: PX626-QJD

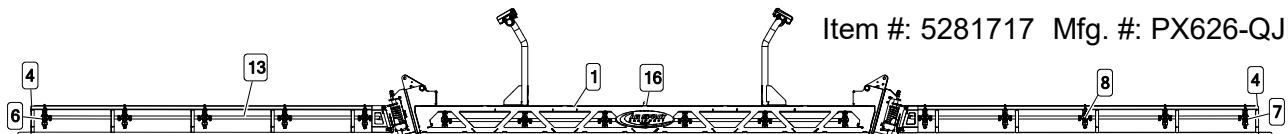

Item #: 5281719 Mfg. #: PX630-QJD

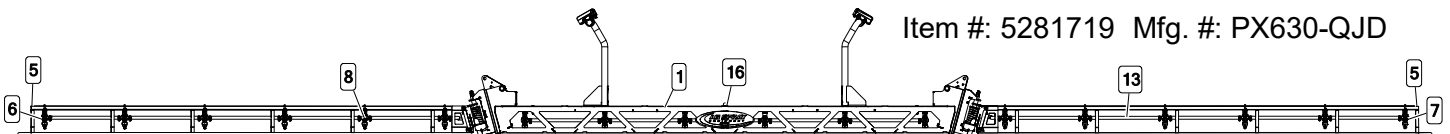

PX4 BOOM SST Wet Boom (ASM) Triple Nozzle Bodies

Ref. #	Part #	Description	PX620-ASM	PX623-ASM	PX626-ASM	PX630-ASM
			Qty.	Qty.	Qty.	Qty.
1	5281737	Assembly PX Boom 6-Nozzle Center Section	1	1	1	1
2	5281733-CBK	PX Boom Wing Weldment, 3-Nozzle	2	-	-	-
3	5281731-CBK	PX Boom Wing Weldment, 4-Nozzle	-	2	-	-
4	5281734-CBK	PX Boom Wing Weldment, 5-Nozzle	-	-	2	-
5	5281735-CBK	PX Boom Wing Weldment, 6-Nozzle	-	-	-	2
6	24216A-1/2-NYB	TeeJet 1/2" Pipe Wetboom Triple Nozzle Body	12	14	16	18
7	5281725	Kit, Wilger 1/2" Wet Boom 20' x 3 Sect 20" Off Cntr	1	-	-	-
7.1	5011283	1/2" Wet Boom Pipe, 50.595"L , 20" Spacing	2	-	-	-
7.2	5011287	1/2" Wet Boom Pipe, 43.750"L , 20" Spacing	2	-	-	-
7.3	5034856	QN 1/2" SST Nut	7	-	-	-
7.4	5072544	O-Ring	9	-	-	-
7.5	5118211	QN Hose Shank 1/2" SST x 1/2" Straight	1	-	-	-
7.6	5149203	QN Hose Shank - 1/2" SST x 1/2" Sweep, 90°	2	-	-	-
7.7	5149204	QN Sweep Tee - 1/2" SST x 1/2" SST x 1/2" SST	1	-	-	-
7.8	5149205	QN Plug - 1/2" SST x Plug Cap	4	-	-	-
7.9	5149207	QN Male Tube End Adapter - 0.840" x 1/2" SST	OPT	-	-	-
8	5281726	Kit, Wilger 1/2" Wet Boom 23' x 3 Sect 20" Off Cntr	-	1	-	-
8.1	5011283	1/2" Wet Boom Pipe, 50.595"L , 20" Spacing	-	2	-	-
8.2	5011284	1/2" Wet Boom Pipe, 63.750"L , 20" Spacing	-	2	-	-
8.3	5034856	QN 1/2" SST Nut	-	7	-	-
8.4	5072544	O-Ring	-	9	-	-
8.5	5118211	QN Hose Shank 1/2" SST x 1/2" Straight	-	1	-	-
8.6	5149203	QN Hose Shank - 1/2" SST x 1/2" Sweep, 90°	-	2	-	-
8.7	8149204	QN Sweep Tee - 1/2" SST x 1/2" SST x 1/2" SST	-	1	-	-
8.8	5149205	QN Plug - 1/2" SST x Plug Cap	-	4	-	-
8.9	5149207	QN Male Tube End Adapter - 0.840" x 1/2" SST	-	OPT	-	-
9	5281727	Kit, Wilger 1/2" Wet Boom 20' x 3 Sect 20" Off Cntr	-	-	1	-
9.1	5011283	1/2" Wet Boom Pipe, 50.595"L , 20" Spacing	-	-	2	-
9.2	5011289	1/2" Wet Boom Pipe, 83.750"L , 20" Spacing	-	-	2	-
9.3	5034856	QN 1/2" SST Nut	-	-	7	-
9.4	5072544	O-Ring	-	-	9	-
9.5	5118211	QN Hose Shank 1/2" SST x 1/2" Straight	-	-	1	-
9.6	5149203	QN Hose Shank - 1/2" SST x 1/2" Sweep, 90°	-	-	2	-
9.7	8149204	QN Sweep Tee - 1/2" SST x 1/2" SST x 1/2" SST	-	-	1	-
9.8	5149205	QN Plug - 1/2" SST x Plug Cap	-	-	4	-
9.9	5149207	QN Male Tube End Adapter - 0.840" x 1/2" SST	-	-	OPT	-
10	5281724	Kit, Wilger 1/2" Wet Boom 23' x 3 Sect 20" Off Cntr	-	-	-	1
10.1	5011283	1/2" Wet Boom Pipe, 50.595"L , 20" Spacing	-	-	-	2
10.2	5011288	1/2" Wet Boom Pipe, 103.854"L , 20" Spacing	-	-	-	2
10.3	5034856	QN 1/2" SST Nut	-	-	-	7
10.4	5072544	O-Ring	-	-	-	9
10.5	5118211	QN Hose Shank 1/2" SST x 1/2" Straight	-	-	-	1
10.6	5149203	QN Hose Shank - 1/2" SST x 1/2" Sweep, 90°	-	-	-	2
10.7	8149204	QN Sweep Tee - 1/2" SST x 1/2" SST x 1/2" SST	-	-	-	1
10.8	5149205	QN Plug - 1/2" SST x Plug Cap	-	-	-	4
10.9	5149207	QN Male Tube End Adapter - 0.840" x 1/2" SST	-	-	-	OPT
11	5281729	Parts Bag, 1/2" Wet Boom Clamp Kit	8	10	12	12
11.1	5034858	1/4-20 x 1.05 x 3.00 Square U-Bolt	1	1	1	1
11.2	5038958-CBK	WET BOOM CLAMP BRACKET - PX BOOM	1	1	1	1
11.3	5051174	1/2 Wet Boom Clamp (2 Halves)	1	1	1	1
11.4	5006344	1/4-20 Flanged Top-Lock Hex Nut	2	2	2	2

PX6 BOOM SST Wet Boom (ASM) Triple Nozzle Bodies

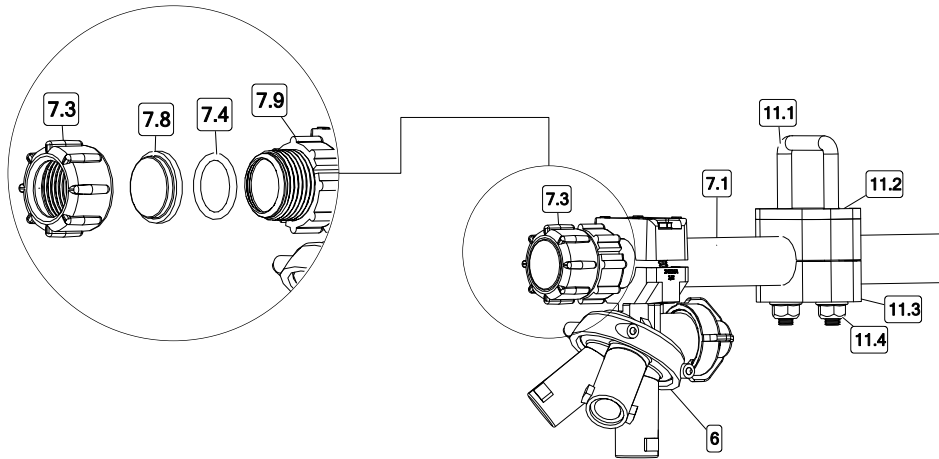
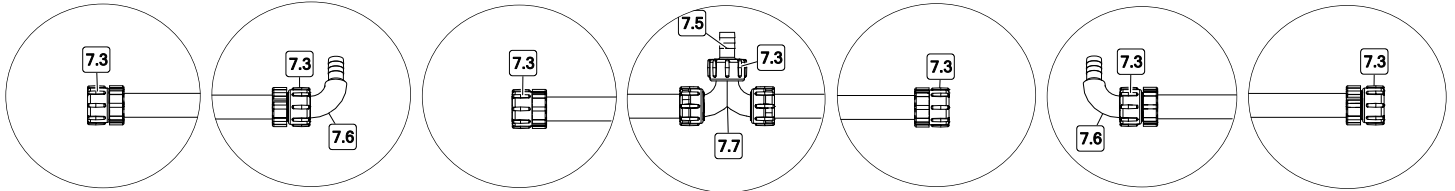

NOTE:
For parts 8.* , 9.* or 10.* , refer to part numbers for 7.*

Examples:
8.3, 9.3, 10.3 would be the same part number as 7.3.
8.5, 9.5, 10.5 would be the same part number as 7.5 and so on.

Refer below for placements of 7.1, 7.2, 8.1, 8.2, 9.1, 9.2, 10.1 & 10.2 as boom pipes are different lengths.

Item #: 5281714 Mfg. #: PX620-ASM

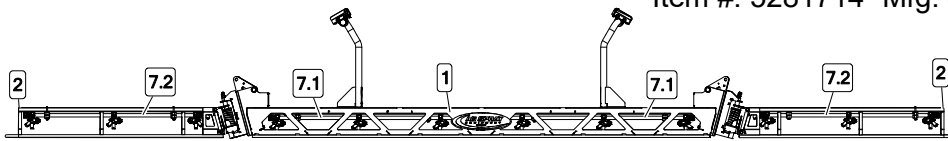

Item #: 5281716 Mfg. #: PX623-ASM

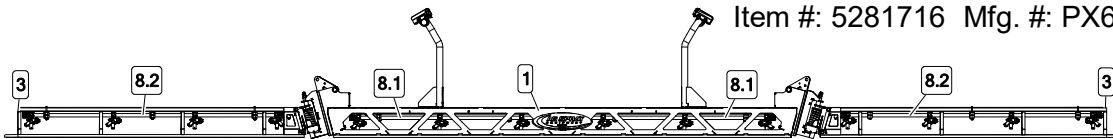

Item #: 5281718 Mfg. #: PX626-ASM

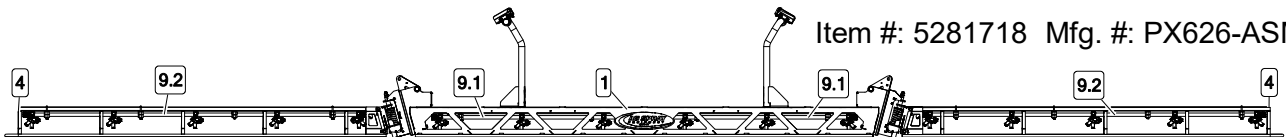

Item #: 5281720 Mfg. #: PX630-ASM

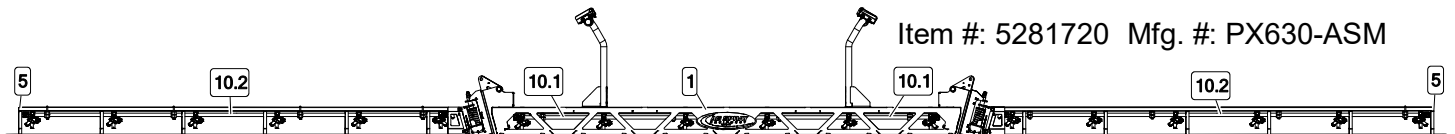

PX Boom Power Fold Options

PX Boom Hydraulic Fold Option (Item # 5281777, 5281778, 5281779)

Note: PX Boom Hydraulic Fold Kits are equipped with restrictors in the elbow fittings threaded into the cylinders. Restrictors limit cylinder travel speed to prevent premature boom damage.

Warning: Always be aware of surroundings when folding and unfolding boom, especially overhead powerlines.

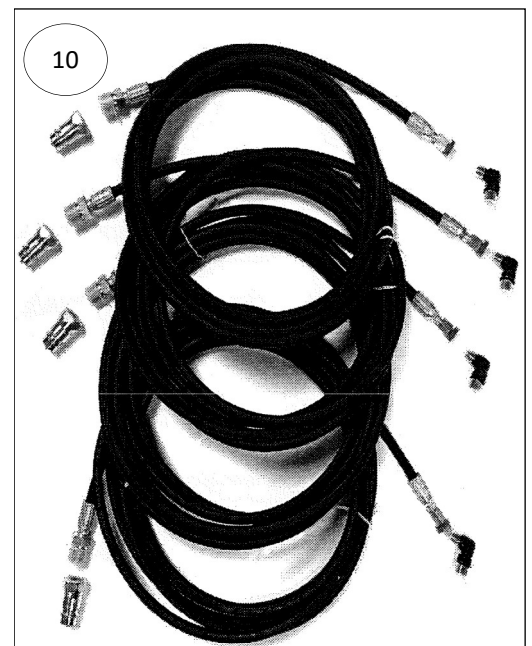
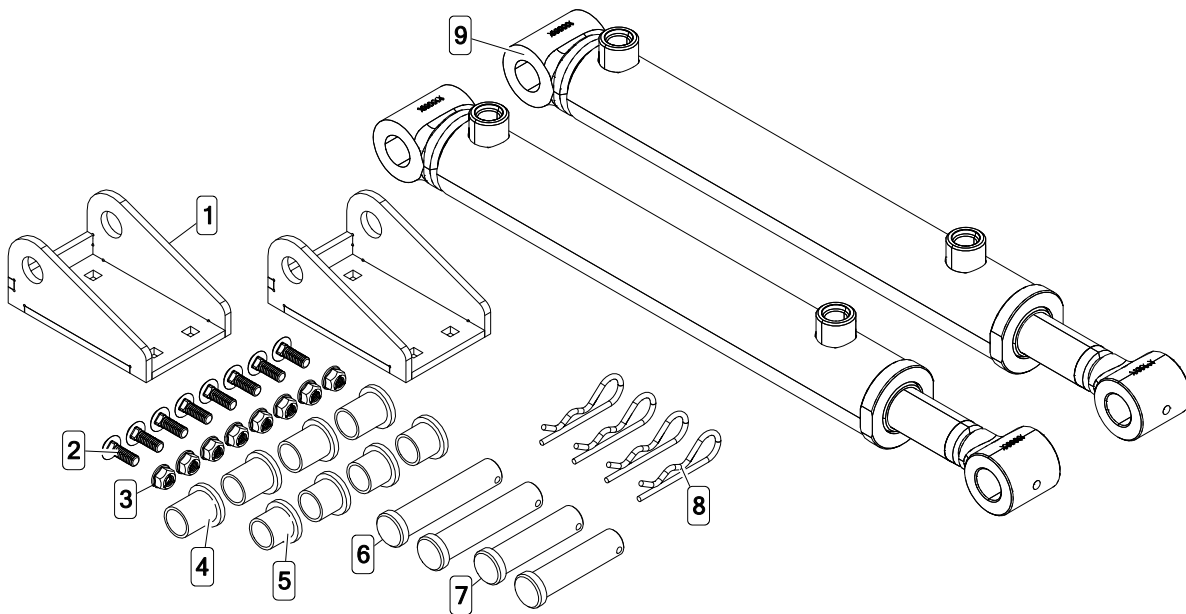
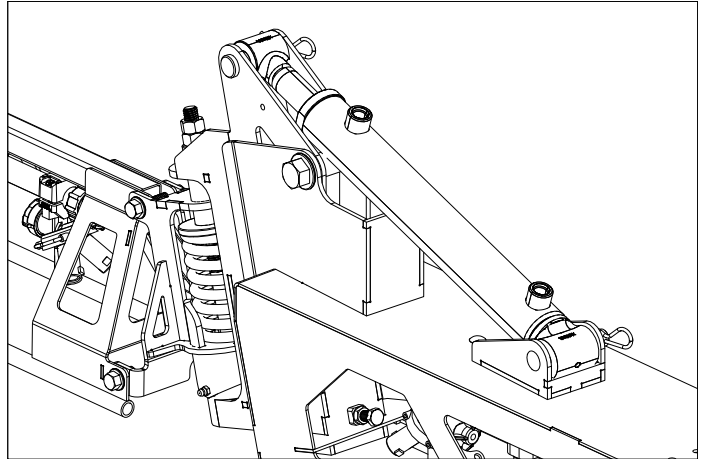

Ref. #	Part #	Description	Qty.
1	5281747	PX Boom Cylinder Mount	2
2	5034481	1/4-20 x 0.75 Carriage Bolt	8
3	5006344	1/4-20 Flanged Top-Lock Hex Nut	8
4	5031511	Flanged Sleeve Bearing, .625 ID x 1"	4
5	5031512	Flanged Sleeve Bearing, .625 ID x .750"	4
6	5101374	Clevis Pin, 5/8" Dia. X 2.75 Usable Length	2
7	5101375	Clevis Pin, 5/8" Dia. X 2.25 Usable Length	2
8	5101065	Hair Pin, #211 x 2.50	4
9	5061060	Hydraulic Cylinder, 1.5" c 10", 1.00" Rod	2
10A	5281771	Hydraulic Hose Kit, 13' for PX-HF Boom	-
10B	5281772	Hydraulic Hose Kit, 18' for PX-HF Boom	-
10C	5281773	Hydraulic Hose Kit, 22' for PX-HF Boom	-

Ref. #	Part #	Description	Qty.
1	5281747	PX Boom Cylinder Mount Weldment	2
2	5034481	1/4-20 0.75 Carriage Bolt	8
3	5006344	1/4-20 Flanged Top-Lock Hex Nut	8
4	5031513	Sleeve Bearing, .625 ID x 0.877 OD x .625" Long	4
5	5031514	Sleeve Bearing, .625 ID x 0.877 OD x .50" Long	4
6	5101374	Clevis Pin, 5/8" Dia. X 2.75 Usable Length	2
7	5101375	Clevis Pin, 5/8" Dia. X 2.25 Usable Length	2
8	5101065	Hair Pin, #211 x 2.50	4
9	5143550	KYB Actuator, 40-20 x 250 mm Stroke	2
10	5157269	Control Box w/30 Amp Auto-Reset Fuse	1
11	5043038	Power Cable 8' for PX Electric Fold	1
12	5043039	Output End Cable 8' for PX Electric Fold	1
13	5043040	Output Extension Cable 10' for PX Electric Fold	1
14	5043041	Output Extension Cable 5' for PX Electric Fold	OPT
15	5157270	Fuse 30 Amp Auto-Reset	1

**PX Boom 12 Volt Electric Fold Option
(Item # 5281774, 5281775, 5281776)**

12V Connection Guideline:

Red = Positive (+) Black = Ground (-)
Connect Directly to Battery or Minimum 30 Amp Power Supply.

30 Amp Auto-Reset Fuse: If while folding or unfolding the boom stops moving, release the boom switch for 3 to 5 seconds and the fuse will auto-reset. Resume normal operation.

**Yellow - Green 2 Pin Plug = Right 12V Actuator/Switch
Red - Black 2 Pin Plug = Left 12V Actuator/Switch**

Warning: Always be aware of surroundings when folding and unfolding boom, especially overhead powerlines.

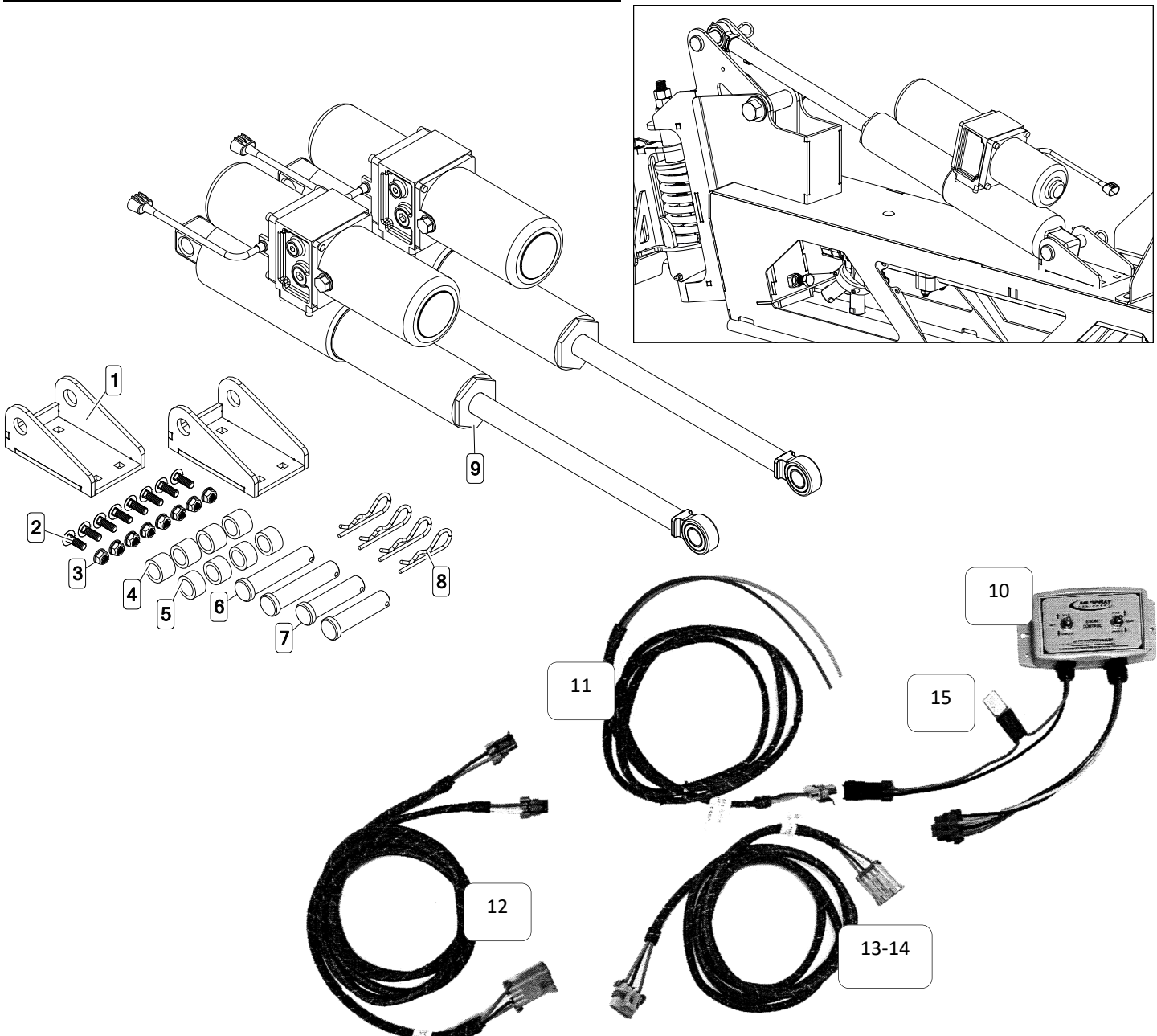

PX Boom Mount Kit

PX Trailer & 3-Point Boom Mount Kit #5281836

Ref. #	Part #	Description	Qty.
1	5006344	1/4-20 Flanged Top-Lock Hex Nut	8
2	5006399	1/2-13 Flanged Top-Lock Hex Nut	10
3	5034481	1/4-20 x 0.75 Carriage Bolt	8
4	5034691	1/2-13 x 1.25 Flanged Hex Bolt	8
5	5034704	1/2-13 x 4.50 Flanged Hex Bolt (Full Thread)	2
6	5095985	PX Boom Mount Riser (LH)	1
7	5095986	PX Boom Mount Adaptor	2
8	5095987	PX Boom Mount Riser (RH)	1

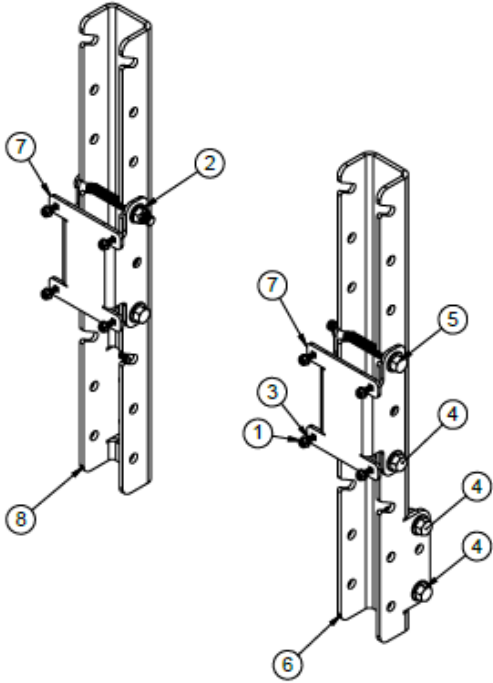

Warranty Info

LIMITED WARRANTY FOR NEW AG SPRAY EQUIPMENT

WHO MAY USE THIS LIMITED WARRANTY. This limited warranty (the "Limited Warranty") is provided by Fimco, Inc. ("Ag Spray Equipment") to the original purchaser ("you") of the Equipment (as defined below) from Ag Spray Equipment or one of Ag Spray Equipment's authorized dealers. This Limited Warranty does not apply to any subsequent owner or other transferee of the Equipment. THIS LIMITED WARRANTY GIVES YOU SPECIFIC LEGAL RIGHTS, AND YOU MAY ALSO HAVE OTHER RIGHTS WHICH VARY FROM STATE TO STATE.

WHAT THIS LIMITED WARRANTY COVERS AND FOR HOW LONG. Ag Spray Equipment warrants that any registered new Equipment will be free from defects in material and workmanship for a period of **one (1) year** after delivery of the Equipment to you (the "Warranty Period"). The Warranty Period is not extended if Ag Spray Equipment repairs or replaces the Equipment.

WHAT IS NOT COVERED BY THIS LIMITED WARRANTY. This Limited Warranty does not apply to: (1) used Equipment; (2) any Equipment that has been altered, changed, repaired or treated since its delivery to you, other than by Ag Spray Equipment or its authorized dealers; (3) damage or depreciation due to normal wear and tear; (4) defects or damage due to failure to follow Ag Spray Equipment's operator's manual, specifications or other written instructions, or improper storage, operation, maintenance, application or installation of parts; (5) defects or damage due to misuse, accident or neglect, "acts of God" or other events beyond Ag Spray Equipment's reasonable control; (6) accessories, attachments, tools or parts that were not manufactured by Ag Spray Equipment, whether or not sold or operated with the Equipment; or (7) rubber parts, such as tires, hoses and grommets.

HOW TO OBTAIN WARRANTY SERVICE. To obtain warranty service under this Limited Warranty, you must (1) provide written notice to Ag Spray Equipment of the defect during the Warranty Period and within **thirty (30)** days after the defect becomes apparent or the repair becomes necessary, at the following address: Ag Spray Equipment, 1000 Fimco Lane, North Sioux City, SD 57049; and (2) make the Equipment available to Ag Spray Equipment or an authorized dealer within a reasonable period of time. For more information about this Limited Warranty, please call: **800-274-1025**

WHAT REMEDIES ARE AVAILABLE UNDER THIS LIMITED WARRANTY. If the conditions set forth above are fulfilled and the Equipment or any part thereof is found to be defective, Ag Spray Equipment shall, at its own cost, and at its option, either repair or replace the defective Equipment or part. Ag Spray Equipment will pay for shipping and handling fees to return the repaired or replacement Equipment or part to you.

LIMITATION OF IMPLIED WARRANTIES AND OTHER REMEDIES. THE REMEDIES DESCRIBED ABOVE ARE YOUR SOLE AND EXCLUSIVE REMEDIES, AND AG SPRAY EQUIPMENT'S SOLE LIABILITY, FOR ANY BREACH OF THIS LIMITED WARRANTY. TO THE EXTENT APPLICABLE, ANY IMPLIED WARRANTIES, INCLUDING, WITHOUT LIMITATION, THE IMPLIED WARRANTIES OF MERCHANTABILITY AND FITNESS FOR A PARTICULAR PURPOSE, SHALL BE LIMITED IN DURATION TO THE WARRANTY PERIOD, AND THE REMEDIES AVAILABLE FOR BREACH THEREOF SHALL BE LIMITED TO THE REMEDIES AVAILABLE UNDER THIS EXPRESS LIMITED WARRANTY. SOME STATES DO NOT ALLOW LIMITATIONS ON HOW LONG AN IMPLIED WARRANTY LASTS, SO THE ABOVE LIMITATION MAY NOT APPLY TO YOU. IN NO EVENT SHALL AG SPRAY EQUIPMENT'S LIABILITY UNDER THIS LIMITED WARRANTY EXCEED THE ACTUAL AMOUNT PAID BY YOU FOR THE DEFECTIVE EQUIPMENT, NOR SHALL AG SPRAY EQUIPMENT BE LIABLE, UNDER ANY CIRCUMSTANCES, FOR ANY CONSEQUENTIAL, INCIDENTAL, SPECIAL OR PUNITIVE DAMAGES OR LOSSES, WHETHER DIRECT OR INDIRECT. SOME STATES DO NOT ALLOW THE EXCLUSION OR LIMITATION OF INCIDENTAL OR CONSEQUENTIAL DAMAGES, SO THE ABOVE LIMITATION OR EXCLUSION MAY NOT APPLY TO YOU.



BAKERSFIELD, CA
4618 SACO RD, 93308
661.391.9081
Toll Free: 877.724.2236
F: 661.391.9085
BAKERSFIELD@AGSPRAY.COM

COLUMBUS, NE
5834 23rd ST, 68601
402.564.4544
Toll Free: 800.274.1025
F: 402.564.0549
COLUMBUS@AGSPRAY.COM

DOTHAN, AL
2401 FORRESTER RD, 36301
334.673.0580
Toll Free: 800.227.4098
F: 334.673.1974
DOTHAN@AGSPRAY.COM

FARGO, ND
4350 48th AVE N, 58102
701.280.2862
Toll Free: 800.373.4084
F: 701.293.0961
FARGO@AGSPRAY.COM

HOPKINSVILLE, KY
3303 PEMBROKE RD, 42240
270.886.0296
Toll Free: 800.637.7172
F: 270.885.7392
HOPKINSVILLE@AGSPRAY.COM

MANKATO, MN
907 SOUTHBEND AVE, 56001
507.377.6295
Toll Free: 800.722.9376
F: 507.388.4668
MANKATO@AGSPRAY.COM

NEWTON, KS
7000 SCHABEN CT, 67114
316.283.4444
Toll Free: 800.394.7662
F: 316.293.4646
NEWTON@AGSPRAY.COM

PASCO, WA
3035 TRAVEL PLAZA WAY, 99301
509.488.6631
Toll Free: 800.634.2026
F: 509.488.2927
OTHELLO@AGSPRAY.COM

TEMPE, AZ
8464 KYRENE RD, 85284
480.705.8047
Toll Free: 877.705-8047
F: 480.705.8048
TEMPE@AGSPRAY.COM